

## Industrial Cordless Tools



-  SCB series
  SC series
  WRTBA series
-  Geared Type series
  PW series
  Accessories

## Tool Selection Chart

### BOLT

#### GRADE at 8.8

##### SCB series

SC180BBS3  
SC180BBS6  
SC180BBS9  
SC180BBS12

##### SC series

SC108BS3L  
SC108BS5B  
SC108BS8I  
SC108BS11F  
SC108BS12D  
SC108BS12B  
SC108BS12E  
SC108BS12Z

##### WRTBA series

WRTBA-10  
WRTBA-10S2  
WRTBA-10S3  
WRTBA-16  
WRTBA-16S2  
WRTBA-16S3  
WRTBA-30S3  
WRTBA-35S3  
WRTBA-50S3(4)  
WRTBA-70S3(4)

##### PW series

PW-15  
PW-15S3  
PW-25  
PW-25S3  
PW-35  
PW-35S3  
PW-45  
PW-45S3

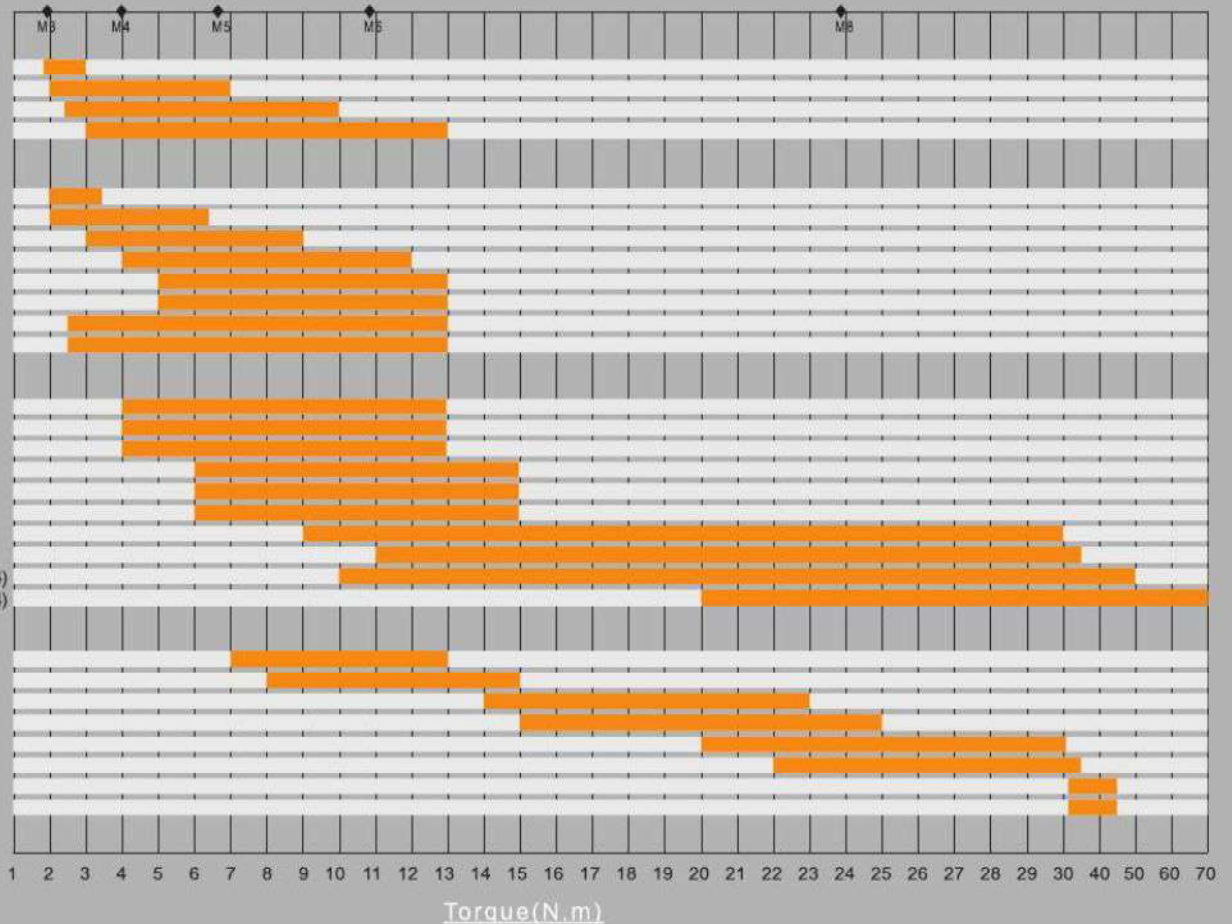

## TORQUE RANGE REFERENCE

Torque is a very important reference value while choosing a right tool for tightening. Due to nut sizes, joint types, air pressure and working environment, the actual tightening torque may vary. The table above is only for a reference to choose the right tool. When the working torque is at the mean value of the torque range, the tool provides the best performance.

### Tightening Torque (N.m)

This table shows the recommended tightening torque for common bolt size M2 to M16. According to ISO 898-1

Bolt Size	Bolt Grade							Bolt Size	Bolt Grade					
mm	3.6	4.6	4.8	5.8	8.8	10.9	12.9	mm	4.6	4.8	5.8	8.8	10.9	12.9
M2	0.10	0.13	0.17	0.22	0.35	0.49	0.58	M8	8.9	10.5	15	24	33	40
M3	0.35	0.46	0.61	0.77	1.20	1.70	2.10	M10	17	21	29	47	65	79
M4	0.81	1.10	1.40	1.80	2.90	4.00	4.90	M12	30	36	51	81	114	136
M5	1.60	2.20	2.95	3.60	5.70	8.10	9.70	M14	48	58	80	128	181	217
M6	2.80	3.70	4.90	6.10	9.80	14.0	17.0	M16	74	88	123	197	277	333

### Torque Conversion

Nm	Ft-lbs	Nm	Ft-lbs	Nm	Ft-lbs	Nm	Ft-lbs	Nm	Ft-lbs
0.8	0.59	1.7	1.25	8	5.90	17	12.53	30	22.11
0.9	0.66	1.8	1.33	9	6.63	18	13.26	35	25.79
1	0.74	1.9	1.40	10	7.37	19	14.00	40	29.48
1.1	0.81	2	1.47	11	8.11	20	14.74	45	33.16
1.2	0.88	3	2.21	12	8.84	21	15.48	50	36.85
1.3	0.96	4	2.95	13	9.58	22	16.21	55	40.53
1.4	1.03	5	3.68	14	10.32	23	16.95	60	44.22
1.5	1.11	6	4.42	15	11.05	24	17.69	65	47.90
1.6	1.18	7	5.16	16	11.79	25	18.42	70	51.68



## SCB Series | Brushless motor

-Cordless Shut-off Screwdriver-



### Mini USB Connector:

Tool speed can be adjusted by additional programmer.

LED indicator provides simple process information to the operator. The signal is visible from any angle.



Push "R" for switching F/R operation.



Blue light indicates that the tool is in reverse operation.



Green light indicates that the preset torque is reached and tightening is completed.



Red light with a long "beep" sound indicates that the tightening was failed.



Yellow light with a "beep" sound indicates that the battery is dead. Must change the battery pack immediately.



Yellow Flashing light with five short beep sounds indicates low battery.

## SPECIFICATIONS

Model	Volt.	Drive Size	Screw Size	Weight w/o Batt.		Vibration Value	Noise Level	Free Speed	Torque Range (N.m)	
	V	in	mm	kg	lb	m/s <sup>2</sup>	dB(A)	rpm	Hard joint	Soft joint
SC180BBS3	18	1/4" Hex.	M3~M4	0.95	2.1	<2.5	<75	500~1,550	0.8~3	0.8~3
SC180BBS6	18	1/4" Hex.	M3~M5	0.95	2.1	<2.5	<75	300~900	1~6	1~6
SC180BBS9	18	1/4" Hex.	M3~M5	0.95	2.1	<2.5	<75	300~700	1.5~9	1.5~9
SC180BBS12	18	1/4" Hex.	M4~M6	0.95	2.1	<2.5	<75	250~550	2~12	2~12

Adjustment screwdriver, spanner, marking color ring are included with the tool.

## Applications

- Assembly applications where torque accuracy is required.
- Areas where pneumatic or electric tools are impractical to use due to hoses/cables.
- Especially used on car interior assembly.
- Attaching components to the dashboard.
- Hose clips on turbo chargers and air intakes, heating and climate systems and coolant circuits.

## Product Strengths

- Adopting with the innovative Lithium-ion battery technology that extends the operating time of one fully charged battery to be longer than the Ni-Cad and the Ni-MH battery.
- Lithium-ion battery has no memory effect which extends the cycle life of the battery.
- The unique design of low battery warning that reminds operators the time to change the battery.
- Brushless motor has longer life time and wear-free parts that lower maintenance and spare part costs.
- Tool speed can be adjusted for different applications.
- Soft grip handle reduces vibration and fatigue.
- Torque accuracy : Meets ISO 5393 Cmk>1.67 at  $\pm 10\%$  tolerance.

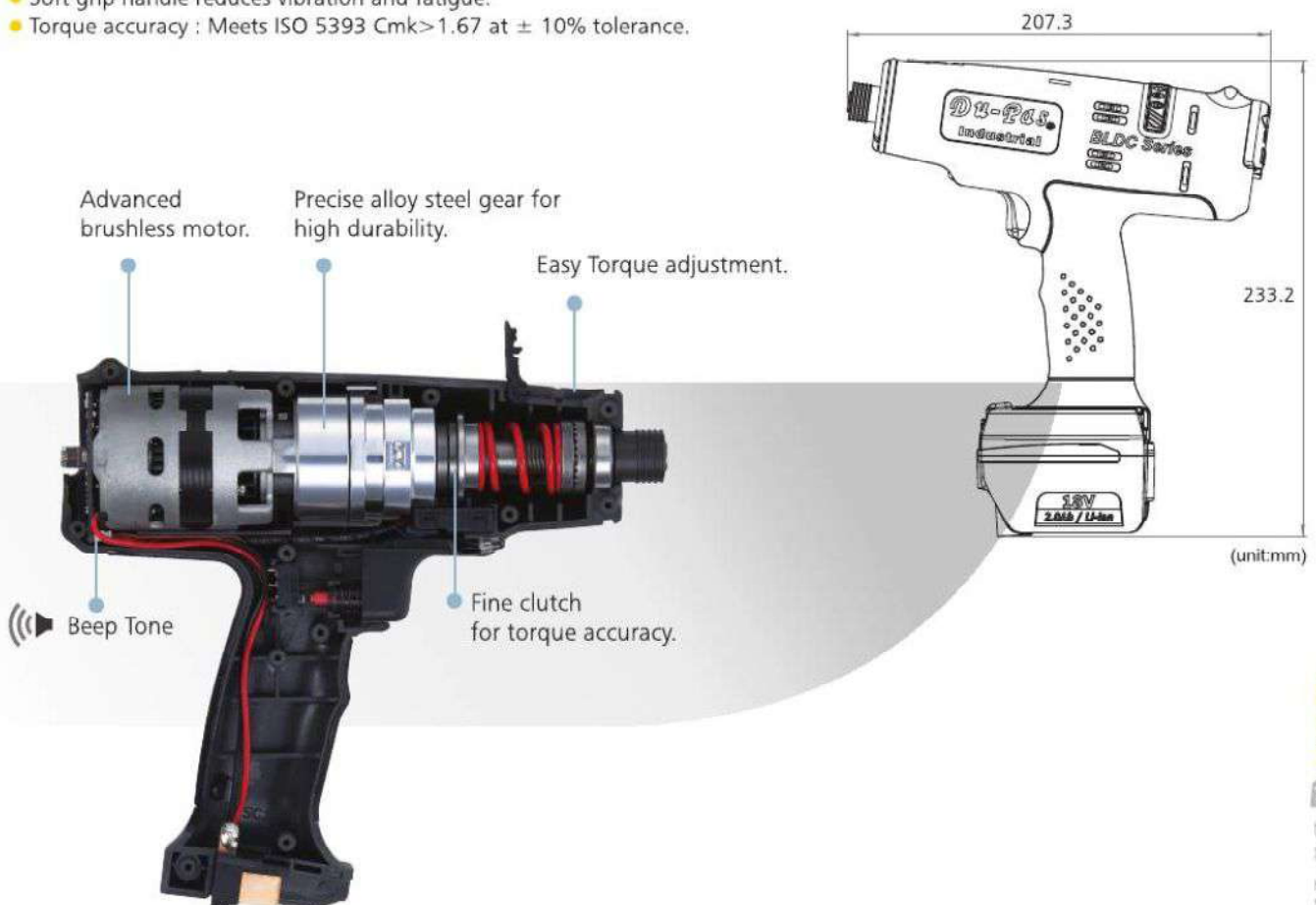

## SC Series | Brushed motor

-Cordless Shut-off Screwdriver-



Green light indicates the preset torque is reached and the tightening is OK.



Red light with a long beep sound indicates that the preset torque is not reached.



Yellow flashing with five short "beep" sounds indicates low battery.



Yellow light with a long "beep" sound indicates that the battery is dead. Must change the battery immediately.

### Applications

- Assembly applications where torque accuracy is required.
- Areas where pneumatic or electric tools are impractical to use due to hoses/cables.
- Especially used on car interior assembly.
- Attaching components to the dashboard.
- Hose clips on turbo chargers and air intakes, heating and climate systems and coolant circuits.

### Product Strengths

- Adopting with the innovative Lithium-ion battery technology that extends the operating time of one full charged battery to be longer than the Ni-Cad and the Ni-MH battery.
- Lithium-ion battery has no memory effect which extends the cycle life of the battery.
- The unique design of low battery warning that reminds operators the time to change the battery.
- The ergonomic handle design makes work easier and effort-saving that promotes the work efficiency.
- Torque accuracy : Meets ISO 5393 Cmk>1.67 at  $\pm 10\%$  tolerance.



## SPECIFICATIONS

Model	Volt.	Drive Size	Screw Size	Weight w/o Batt.		Vibration Value	Noise Level	Free Speed	Torque Range (N.m)	
	V	in	mm	kg	lb	m/s <sup>2</sup>	dB(A)	rpm	Hard joint	Soft joint
SC108BS3L	10.8	1/4" Hex.	M3~M4	1.0	2.2	<2.5	<75	1,100	1~3.5	1~3.5
SC108BS5B	10.8	1/4" Hex.	M3~M5	1.0	2.2	<2.5	<75	170	1~5.5	1~5.5
SC108BS8I	10.8	1/4" Hex.	M4~M5	1.0	2.2	<2.5	<75	800	2~8	2~8
SC108BS11F	10.8	1/4" Hex.	M4~M6	1.0	2.2	<2.5	<75	500	3~11	3~11
SC108BS12D	10.8	1/4" Hex.	M4~M6	1.0	2.2	<2.5	<75	300	4~12	4~12
SC108BS12B	10.8	1/4" Hex.	M4~M6	1.0	2.2	<2.5	<75	170	4~12	4~12
SC108BS12E	10.8	1/4" Hex.	M4~M6	1.0	2.2	<2.5	<75	470	1.5~12	1.5~12
SC108BS12Z	10.8	1/4" Hex.	M3~M6	1.0	2.2	<2.5	<75	380	1.5~12	1.5~12

Adjustment screwdriver is included with the tool.

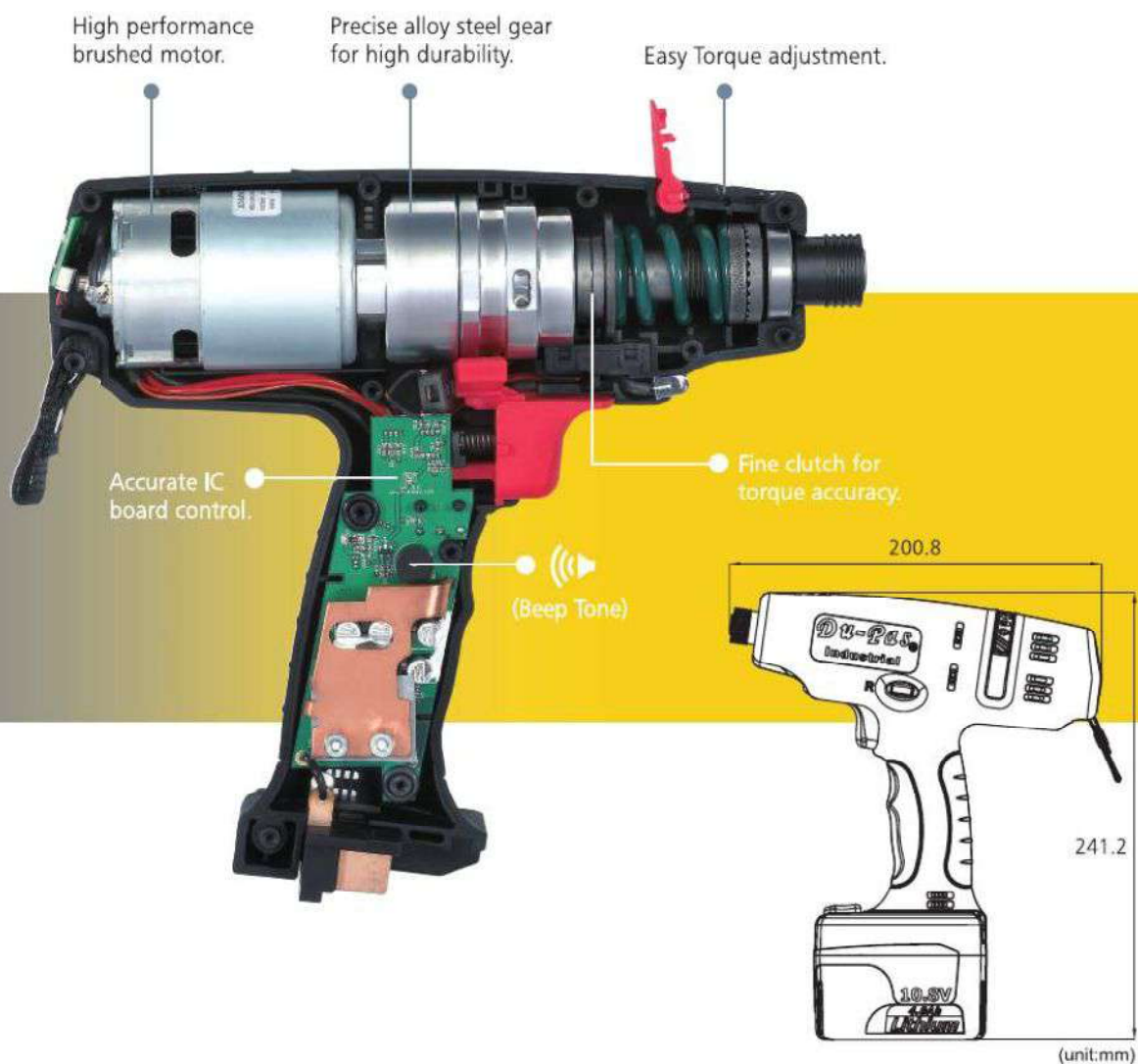

(unit:mm)

## WRTBA Series | Brushless motor

-Cordless Shut-off Angle Wrench/Screwdriver-



### Applications

- Assembly applications where torque accuracy is required.
- Areas where pneumatic or electric tools are impractical to use due to hoses/cables.
- Especially used in cramped spaces.

### Product Strengths

- The high performance brushless motor reduces the harm of environment and provides more fastening cycles per battery charge.
- To use innovative 4.0A.h Li-ion battery makes working time longer than Ni-Cad and Ni-MH batteries.
- Li-ion battery without memory effect so the battery life can be last longer.
- The common use 30 N.m tool is lighter and shorter than other brands, it makes the operation much easier and less fatiguing.
- Torque accuracy: Meets ISO 5393 Cmk>1.67 at  $\pm 10\%$  tolerance.

LED indicator provides simple process information to the operator.



Blue light indicates that the tool is in reverse operation.



Green light indicates the preset torque is reached and the tightening is OK.



Red light with a long beep sound indicates that the preset torque is not reached.



Yellow flashing with five short "beep" sounds indicates low battery.



Yellow light with a long "beep" sound indicates that the battery is dead. Must change the battery immediately.

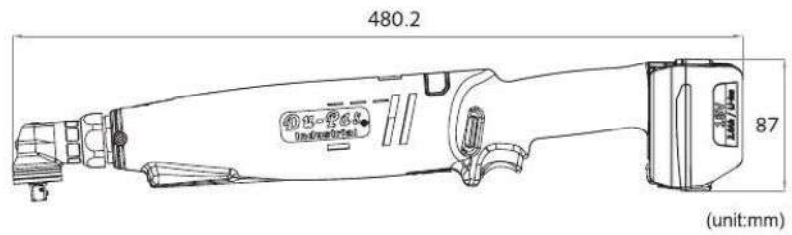

Easy Torque adjustment.

Advanced brushless motor.

Fine clutch for torque accuracy.

Precise alloy steel gear for high durability.

Accurate IC board control.

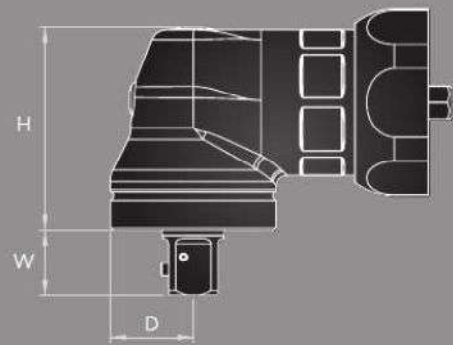

Drive Type	H (mm)	W (mm)	D (mm)
3/8" Sq.	39	12	16
1/4" Sq.	39	9	16
1/4" Hex.	39	20	16

## SPECIFICATIONS

Model	Volt.	Drive Size	Screw Size	Weight w/o Batt.		Vibration Value	Noise Level	Free Speed	Torque Range (N.m)	
	V	in	mm	kg	lb	m/s <sup>2</sup>	dB(A)	rpm	Hard joint	Soft joint
WRTBA-10	18	1/4" Hex.	M4~M5	1.5	3.3	<2.5	<75	400-1000	3-12	3-10
WRTBA-10S2		1/4" Sq.								
WRTBA-10S3		3/8" Sq.								
WRTBA-16	18	1/4" Hex.	M5~M6	1.5	3.3	<2.5	<75	300-600	5-18	5-16
WRTBA-16S2		1/4" Sq.								
WRTBA-16S3		3/8" Sq.								
WRTBA-30S3	18	3/8" Sq.	M6~M8	1.5	3.3	<2.5	<75	250-450	8-30	8-22
WRTBA-35S3	18	3/8" Sq.	M6~M8	1.6	3.52	<2.5	<75	200-350	10-35	10-30

Adjustment screwdriver, spanner, suspension bail, marking color ring are included with the tool.



## WRTBA Series | Brushless motor

-Cordless Shut-off Angle Wrench/Screwdriver-

UP TO 70Nm

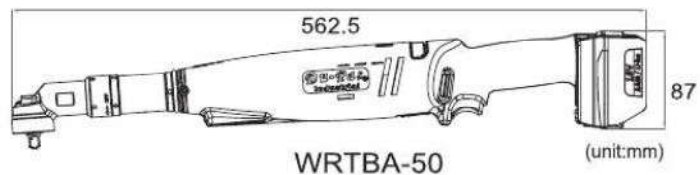
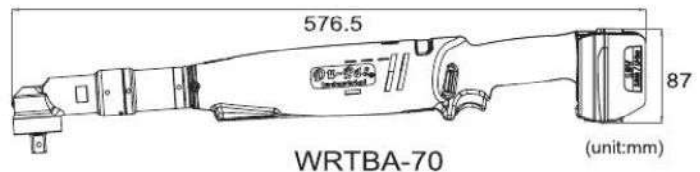
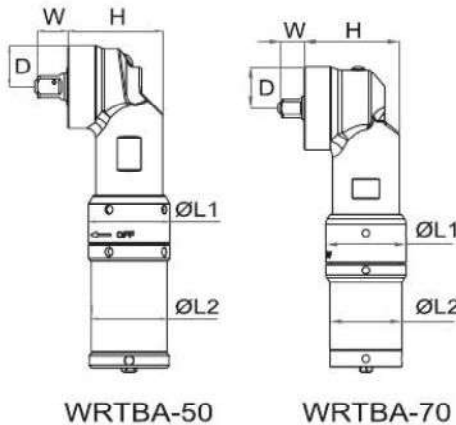

### Drive Type

Model	H (mm)	W (mm)	D (mm)	L1 (mm)	L2 (mm)
WRTBA-50S3	42.5	13.5	18.5	36.5	34
WRTBA-50S4	42.5	18.5	18.5	36.5	34
WRTBA-70S3	50	12	21.7	42	37.6
WRTBA-70S4	50	18	21.7	42	37.6

### SPECIFICATIONS

Model	Volt.	Drive Size	Screw Size	Weight w/o Batt.		Vibration Value	Noise Level	Free Speed	Torque Range (N.m)	
	V	in	mm	kg	lb	m/s <sup>2</sup>	dB(A)	rpm	Hard joint	Soft joint
WRTBA-50S3	18	3/8" Sq.	M6~M10	2.0	4.5	<2.5	<75	200	10~50	10~50
WRTBA-50S4	18	1/2" Sq.	M6~M10	2.0	4.5	<2.5	<75	200	10~50	10~45
WRTBA-70S3	18	3/8" Sq.	M8~M12	2.5	5.5	<2.5	<75	170	20~70	20~70
WRTBA-70S4	18	1/2" Sq.	M8~M12	2.5	5.5	<2.5	<75	170	20~70	20~60

Adjustment screwdriver, spanner, marking color ring are included with the tool.

## Programmer

For Du-Pas cordless tools

More useful functions can be referred to in the Programmer Instruction Manual.



- Easy to set the tool speed.
  - 1.High speed for metallic assemblies.
  - 2.Medium speed for plastic assemblies.
  - 3.Low speed for special assemblies.

- Total used time display function.

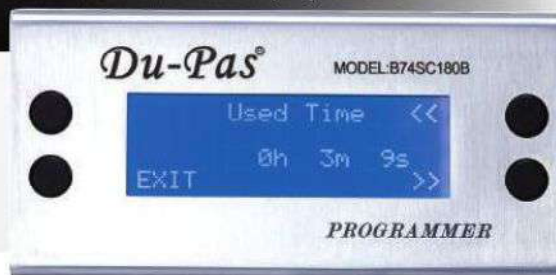

- Total operation count display function.



- Trip operation count display function.





# Geared Type Series

## Angle Type

-Cordless tools-



• WRTBA-30BCA



• WRTBA-10BOA

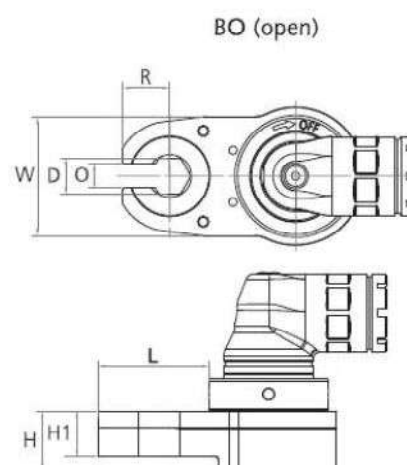
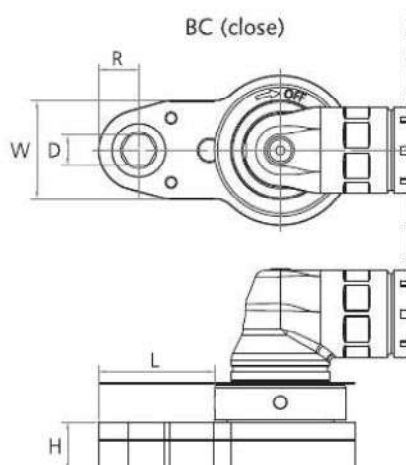

### FEATURES

- This cordless tool series is available for customization to suit users' requirements. It is not to only prioritize the durability, but also enhance the productivity and accessibility.

### DIMENSIONS

(unit:mm)

Model	W	D	O	R	L	H	H1
BC	32	10	-	13.1	37.7	16	-
BO	40	13	10.2	17	40	21	16

Model	Type	Volt.	Hex Dimension	Weight w/o Batt.	Vibration Value	Noise Level	Free Speed	Torque Range (N.m)	
		V	Max(mm)	kg	m/s <sup>2</sup>	d8(A)	rpm	Hard joint	Soft joint
WRTBA-10BCA	close	18	12	2.0	<2.5	<75	950	3-8	3-8
WRTBA-16BCA	close	18	12	2.0	<2.5	<75	600	5-13	5-13
WRTBA-30BCA	close	18	12	2.0	<2.5	<75	450	8-18	8-18
WRTBA-10BOA	open	18	19	2.1	<2.5	<75	950	3-7	3-7
WRTBA-16BOA	open	18	19	2.1	<2.5	<75	600	5-12	5-12
WRTBA-30BOA	open	18	19	2.1	<2.5	<75	450	8-17	8-17

## In-Line Type

Cordless tools



• WRTBA-30ICA



• WRTBA-16IOA

IC (close)

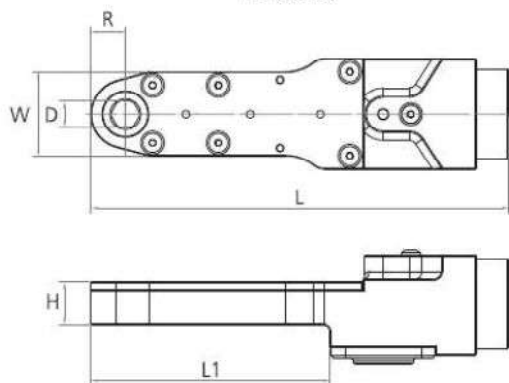

IO (open)

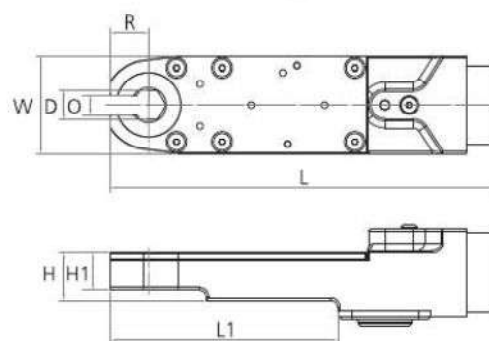

### DIMENSIONS

(unit:mm)

Model	W	D	O	R	L	L1	H	H1
IC	32	10	-	13.1	159	91	16	-
IO	40	13	10.2	17	166.7	98.7	20	16

Model	Type	Volt.	Hex Dimension	Weight w/o Batt.	Vibration Value	Noise Level	Free Speed	Torque Range (N.m)	
		V	Max(mm)	kg	m/s <sup>2</sup>	dB(A)	rpm	Hard joint	Soft joint
WRTBA-10ICA	close	18	12	2.2	<2.5	<75	620	5-11	5-11
WRTBA-16ICA	close	18	12	2.2	<2.5	<75	380	8-17	8-17
WRTBA-30ICA	close	18	12	2.2	<2.5	<75	300	11-23	11-23
WRTBA-10IOA	open	18	19	2.3	<2.5	<75	420	7-13	7-13
WRTBA-16IOA	open	18	19	2.3	<2.5	<75	270	10-22	10-22
WRTBA-30IOA	open	18	19	2.3	<2.5	<75	200	13-28	13-28



## PW Series | Brushless motor

-18V Cordless Shut-off Impulse Tools-

*Patented Unique Shut off system*

**Max. Torque**

45 Nm



### SPECIFICATIONS

Model	Volt.	Drive Size	Weight w/o Batt.	Free Speed	Torque range		Pulse unit Type
	V	in	kg	rpm	Hard joint	Soft joint	
PW-15	18	1/4" Hex.	1.15	4500	7-13	5-9	Shut-off
PW-15S3	18	3/8" Sq.	1.14	4500	8-15	6-10	Shut-off
PW-25	18	1/4" Hex.	1.25	4500	14-23	10-16	Shut-off
PW-25S3	18	3/8" Sq.	1.24	4500	15-25	11-17	Shut-off
PW-35	18	1/4" Hex.	1.35	3500	20-31	14-21	Shut-off
PW-35S3	18	3/8" Sq.	1.34	3500	22-35	15-24	Shut-off
PW-45S3	18	3/8" Sq.	1.41	3500	32-45	22-31	Shut-off

- This tool is suitable on hard joint(A joint) and medium soft joint(B joint), i.e. the tightening angle is less than 180 degrees.
- Set the shut-off point(1-9) as short as possible with stabilized torque on the application; 2-4 for hard joint and 3-7 for medium joint.
- The usage of a maximum of 6 bolts per minute is recommended.

## -Du-Pas Superior Electronic Shut-off System-

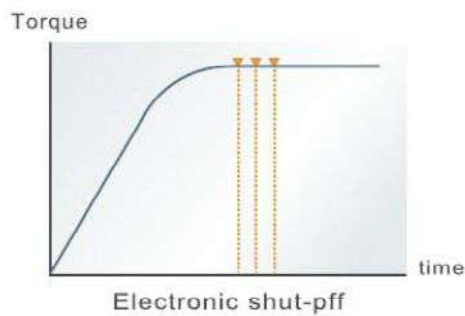

The final torque acquired by electronic shut-off with the impulse setting function is more stable and accurate.

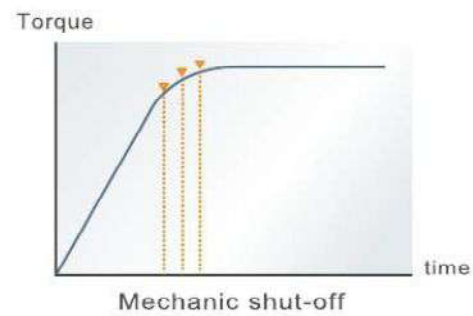

The final torque acquired by mechanic shut-off is easily affected by the change of oil temperature and becomes unstable and inaccurate.

## FEATURES

- The Shut off Point can be adjusted according to different applications and joint types to reach the best performance and work efficiency.  
Shut off Point setting can also be locked to avoid the operators changing uncarefully.
- Reduce the influence of oil temperature inside the pulse unit to improve the torque accuracy.
- Reverse Locked mode let the tool always run at forward direction
- Non-contact Switch provides longer switch life.
- Advanced brushless motor provides longer motor life and better efficiency.
- Ergonomical handle design makes user feel more comfortable.



## LED Indicators

Shut off Point Setting to apply various joint types.



FLASHING YELLOW + FLASHING GREEN = REVERSE OPERATION



GREEN = TIGHTENING OK



RED = TIGHTENING NG



FLASHING YELLOW = LOW BATTERY WARNING



YELLOW = CHANGE BATTERY



# Industrial Riveters

- Cordless Tools -

Ball Screw Mechanism

## RI144BS



## RI180CBH



## RI180CBH

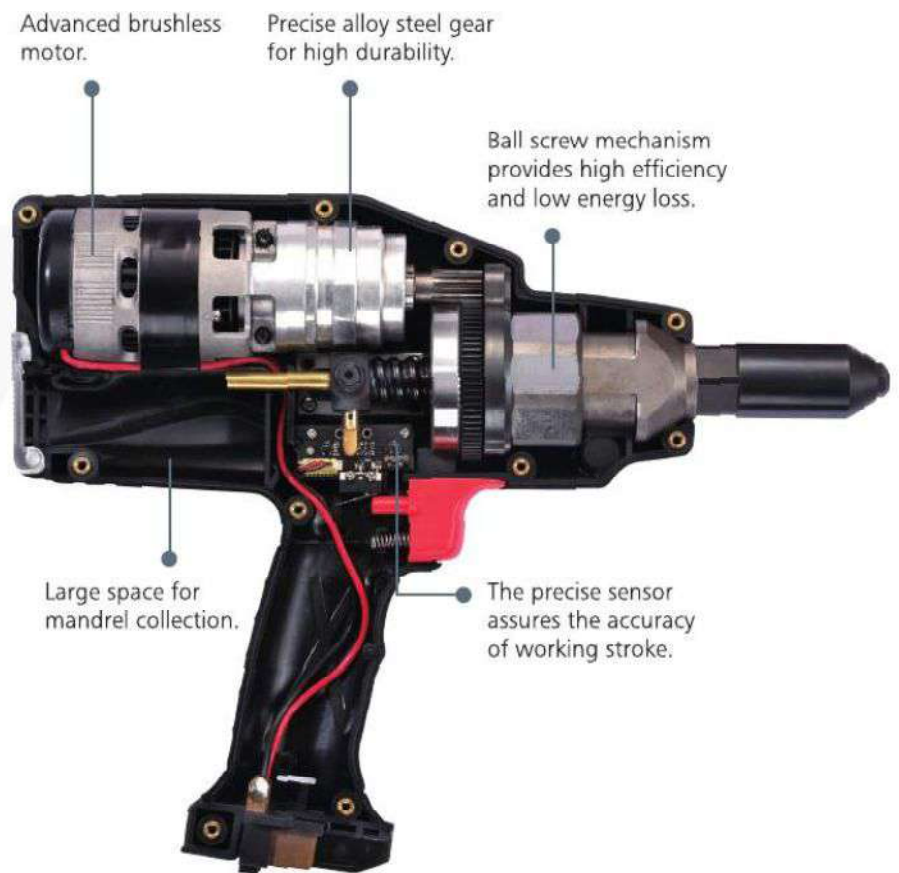

## SPECIFICATIONS

Model	Volt.	Motor type	Battery type	Rivets capacity	Stroke length	Traction power	Pulling time per unit	Weight with 2.0Ah battery		Weight with 4.0Ah battery		Charging time(2.0Ah)	Charging time(4.0Ah)
	V	-	Ah	mm	mm	lb	sec	kg	lb	kg	lb	minute	minute
RI144BS	14.4	Replaceable carbon brush	Li-ion 4.0	2.4~4.8	20	2023	1.0	-	-	2.3	5.06	-	Approx. 85
RI180CBH	18	Brushless motor	Li-ion 2.0/4.0	4.8~6.4	20	2900	1.0	2.1	4.62	2.35	5.17	Approx. 45	Approx. 85

## FEATURES

- Ball screw mechanism provides highest power.
- Short cycle times at full stroke.
- Brushless motor reduce the maintenance cost.
- Precision IC board control.
- Advanced, long-life Li-ion battery.
- Alloy steel gear box for high durability.
- Balanced, ergonomical handle.

## Applications

- Boat
- Construction
- Display shelves
- Furniture
- Heating, Air conditioning
- Lighting fixtures
- Restaurant equipment
- Signs
- Trailers, Cargo container
- Vending machines



## Accessories

-For Du-Pas Industrial Cordless Tools-



BB180C-320



BB108BN-340



BB144C-340



BB180C-340

Part No.	Description	Size (L x W x H)	Charging Time	Weight
BB108BN-340	10.8V 4.0 A.h	93 x 78 x 70 mm	85 min.	0.51 kg (1.12 lb)
BB144C-340	14.4V 4.0 A.h	106 x 79 x 65 mm	85 min.	0.71 kg (1.56 lb)
BB180C-320	18V 2.0 A.h	87 x 79 x 64 mm	45 min.	0.37 kg (0.81 lb)
BB180C-340	18V 4.0 A.h	106 x 79 x 780 mm	85 min.	0.64 kg (1.41 lb)

## Charger



B84192B



B84B

Part No.	Description	Weight
B84B	Input: 100~240 VAC Output: 10.8~14.4 VDC for Li-ion	0.51 kg (1.12 lb)
B84192B	Input: 100~240 VAC Output: 18~19.2 VDC for Li-ion	0.51 kg (1.12 lb)



E86B-UL



E86B-AS



E86B-VD



E86B-UK

### Power cord (for charger use)

Part No.	Description	Weight
E86B-UL	for USA region	62 g (0.13 lb)
E86B-VD	for Europe region	79 g (0.17 lb)
E86B-AS	for Australia region	105 g (0.23 lb)
E86B-UK	for England region	151 g (0.33 lb)

### Angled head ass'y (suit to WRTBA series)



B42WR



B42WR2



B42WR3

Part No.	Description
B42WR	1/4" Hex.
B42WR2	1/4" Sq.
B42WR3	3/8" Sq.

### Marking color ring (suit to WRTBA series)

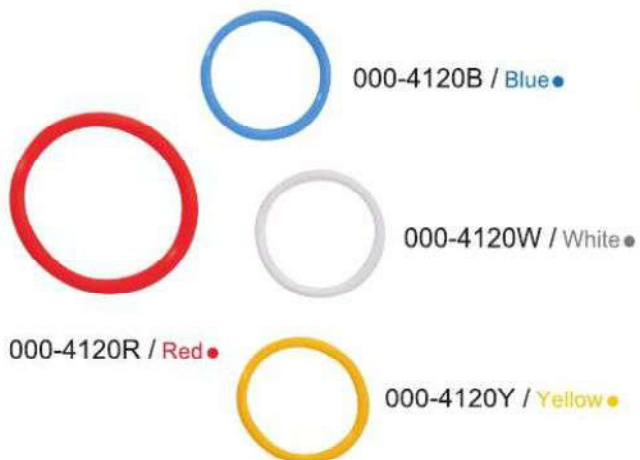

### Marking color ring (suit to SCB series)

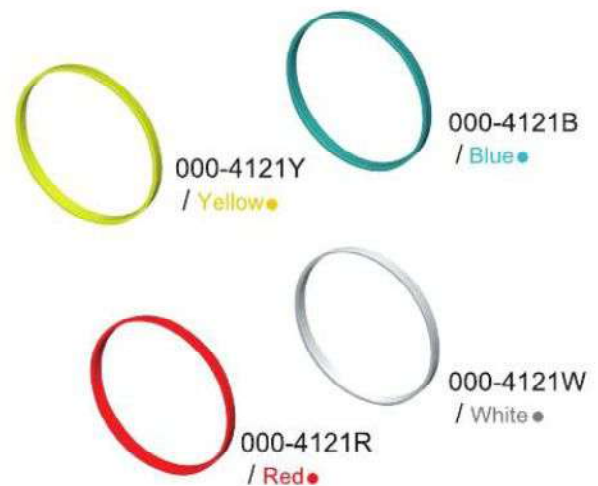



**Adjustment screwdriver**

**Shoulder strap**



» Part No. D40SC108B-1  
( SC series )



» Part No. D57SC108B-1  
( All series )

**Spanner**

**Suspension bail**

( To suspend the tool on a balancer. )



» Part No. D39SC180B-1  
( SCB series )



» Part No. D34WR108B  
( WRTBA series )

**Adjustment Allen Wrench**



» Part No. 000-4610  
( PW series )



» Part No. 000-4621  
( PW-15,PW-15S3 series )



## Tool cover



Part No. C16SC108B  
( SC series )



Part No. C16SC180B  
( SCB series )



Part No. : C16WRB  
( WRTBA series )



Part No. C16PW15  
( PW-15 series )



Part No. C16PW25  
( PW-25 & 35 series )



Part No. C16PW45  
( PW-45 series )

## Battery cover



Part No. C16180C-20  
( for 18V 2.0 A.h battery )



Part No. C16180C-40  
( for 18V 4.0 A.h battery )